



3-pole EMERGENCY STOP



3-pole

Technical data

Ex-safety switches 10 A

| | | |
|--|--|--|
| Marking accd. to 2014/34/EU | Ⓔ II 2 G Ex eb db IIC T6 Gb / Ⓔ II 2 D Ex tb IIIC T80°C Db | |
| EC-Type Examination Certificate | BVS 16 ATEX E 079 | |
| IECEX Certificate of Conformity | IECEX BVS 16.0045 | |
| Marking accd. to IECEx | Ex eb db IIC T6 Gb / Ex tb IIIC T80°C Db | |
| Permissible ambient temperature | -20 °C up to +40 °C ¹⁾ | |
| Rated voltage | up to max. 500 V | |
| Rated current | max. 10 A | |
| Frequency | 50/60 Hz | |
| Rated making-/ breaking capacity AC-3 accd. EN 60947-3 | U _e 230 V / I _e 10 A U _e 400 V / I _e 10 A U _e 500 V / I _e 10 A | |
| Switch-disconnector for maintenance accd. to IEC 62262-1 | Class 1 | |
| Back-up fuse | up to 400 V AC: 20 A gG up to 500 V AC: 16 A gG | |
| Connecting terminals | main contact | 2 x 1.5 - 2.5 mm ² |
| | auxiliary-/Signal contact | 2 x 0.5 - 2.5 mm ² (option) |
| Degree of protection accd. to EN 60529 | IP66 | |
| Protection class | I | |
| Cable glands/enclosure drilling | M20 cable gland see ordering details M25 cable gland see ordering details | |
| Weight | 0.55 kg | |
| Enclosure material | impact resistant polyamide | |
| Enclosure colour | black | |
| Auxiliary contact (option) | 1 x NO making - lagging; breaking - leading | |
| Padlocking facility | can be locked in OFF position with 3 commercially available padlocks (Ø max. 6 mm) | |

¹⁾ Other ambient temperatures on request

GHG 261 - Ex-safety switches 10 A



3-pole



3-pole EMERGENCY STOP

Ordering details

5

| Content | Cable gland | Auxiliary contact | Order No. |
|----------------------------------|-------------------|-------------------|---------------------------|
| Safety switch 10 A 3-pole | | | |
| 3-pole | 2 x M25 / 1 x M20 | 1 NO | GHG 261 0005 R0009 |
| 3-pole | 2 x M25 | none | GHG 261 0007 R0001 |
| 3-pole | 2 x M20 | 1 NO | GHG 261 0005 R0005 |
| 3-pole EMERGENCY STOP | 2 x M25 / 1 x M20 | 1 NO | GHG 261 0005 R0010 |
| 3-pole EMERGENCY STOP | 2 x M25 | none | GHG 261 0007 R0002 |
| Safety switch 10 A 4-pole | | | |
| 4-pole | 2 x M25 | none | GHG 261 0007 R0003 |

Customized version on request, auxiliary contacts in Ex ia available

Accessories

| Type | Application | Fixing method | Order No. |
|--|-----------------------|--------------------|---------------------------|
| Mounting plate for Ex-safety switches 10 A 3-pole | | | |
| Size 1 | Wall mounting | screwless mounting | GHG 610 1953 R0101 |
| Size 1 | Pipe clamp | screwless mounting | GHG 610 1953 R0102 |
| Size 1 | Trellis-work mounting | screwless mounting | GHG 610 1953 R0103 |

| Type | Application | OU | Order No. |
|--|-------------|----|---------------------------|
| Accessories for mounting plates | | | |
| Label holder with type label (blank) for mounting plate size 1, 2, 2A and 3 | | 10 | GHG 610 1953 R0057 |
| Mounting set for pipes 1" (of 27 - 30 mm) for mounting plates with pipe fixing | | 10 | GHG 610 1953 R0020 |

| Type | Application | OU | Order No. |
|-------------------------------------|---------------------------|----|---------------------------|
| Canopies for mounting plates | | | |
| Size 1 | for mounting plate size 1 | 1 | GHG 610 1955 R0101 |

Please pay attention that only order units (OU) according to the ordering details can be delivered.

Dimension drawing

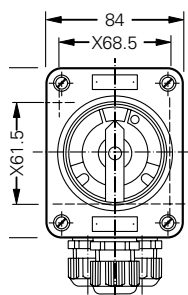

3-pole

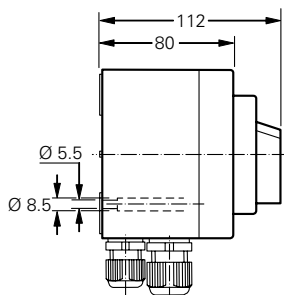

X = fixing dimensions



6-pole EMERGENCY STOP



6-pole



3-pole EMERGENCY STOP



3-pole

Technical data

Ex-safety switches 20 A

| | | |
|---|--|--|
| Marking accd. to 2014/34/EU | ⊕ II 2 G Ex ed ia IIC T6 / ⊕ II 2 D Ex tD A21 IP66 T80 °C | |
| EC-Type Examination Certificate | PTB 99 ATEX 1161 | |
| IECEX Certificate of Conformity | BK1 07.0012 | |
| Marking accd. to IECEx | Ex ed ia IIC T6 Ex tD A21 IP66 T55 °C | |
| Permissible ambient temperature | -20 °C up to +40 °C ¹⁾ | |
| Rated voltage | up to max. 690 V | |
| Rated current | max. 20 A | |
| Frequency | 50/60 Hz | |
| Rated making-/rated breaking capacity AC-3 accd. EN 60947-3 | U _e 230 V / I _e 20 A U _e 400 V / I _e 20 A U _e 500 V / I _e 16 A U _e 690 V / I _e 10 A | |
| Rated making-/ breaking capacity DC 1/DC 23 accd. EN 60947-3 | U _e 60 V / I _e 20 A (1 contact) U _e 120 V / I _e 20 A (2 contacts in series) | |
| Rated making-/ breaking capacity DC-13 (L/R = 100 ms) accd. EN 60947-3 | U _e 60 V / I _e 6 A | |
| Switch-disconnector for maintenance accd. to IEC 62262-1 | Class 1 | |
| Back-up fuse | up to 400 V AC: 35 A gG up to 500 V AC: 35 A gG up to 690 V AC: 25 A gG | |
| Connecting terminals | main contact | max. 2 x 4 mm ² (stranded wire or fine wire) / max. 6 mm ² (pin cable lug) |
| | auxiliary-/Signal contact | 2 x 0.5 - 2.5 mm ² (option) |
| Protection class | I | |
| Degree of protection accd. to EN 60529 | IP66 | |
| Cable glands/enclosure drilling | M20 cable gland see ordering details M25 cable gland see ordering details M32 cable gland see ordering details Option: metal flange with thread | |
| Weight | 3-pole | approx. 1.48 kg |
| | 6-pole | approx. 2.43 kg |
| Enclosure material | glass-fibre reinforced polyester | |
| Enclosure colour | black | |
| Auxiliary contact (option) | 1 x NO making - lagging; breaking - leading 1 x NC (only 6-pole version) making - leading; breaking - lagging | |
| Padlocking facility | can be locked in OFF position with 3 commercially available padlocks (Ø max. 6 mm) | |

¹⁾ Other ambient temperatures on request

GHG 262 - Ex-safety switches 20 A



3-pole



3-pole EMERGENCY STOP



6-pole



6-pole EMERGENCY STOP

Ordering details

5

| Content | Cable gland | Auxiliary contact | Order No. |
|----------------------------------|-------------------|-------------------|--------------------|
| Safety switch 20 A 3-pole | | | |
| 3-pole | 2 x M32 / 1 x M25 | 1 NO | GHG 262 2301 R0001 |
| 3-pole | 2 x M32 | none | GHG 262 2304 R0001 |
| 3-pole EMERGENCY STOP | 2 x M32 / 1 x M25 | 1 NO | GHG 262 2301 R0002 |
| 3-pole EMERGENCY STOP | 2 x M32 | none | GHG 262 2304 R0002 |
| Safety switch 20 A 4-pole | | | |
| 4-pole | 2 x M20 | 1 NO + 1 NC | GHG 262 2301 R0007 |
| 4-pole | 2 x M32 / 1 x M25 | 1 NO + 1 NC | GHG 262 2301 R0009 |
| 4-pole | 2 x M32 | none | GHG 262 2304 R0004 |
| 4-pole | 2 x M20 | none | GHG 262 2304 R0003 |
| 4-pole EMERGENCY STOP | 2 x M32 / 1 x M25 | 1 NO + 1 NC | GHG 262 2301 R0010 |
| Safety switch 20 A 6-pole | | | |
| 6-pole | 4 x M32 / 1 x M25 | 1 NO + 1 NC | GHG 262 2601 R0001 |
| 6-pole | 4 x M25 | 1 NO + 1 NC | GHG 262 2601 R0005 |
| 6-pole EMERGENCY STOP | 4 x M32 / 1 x M25 | 1 NO + 1 NC | GHG 262 2601 R0002 |

Customized version on request, auxiliary contacts in Ex ia available

Accessories

| Type | Application | Fixing method | Order No. |
|--|-----------------------|---------------|--------------------|
| Mounting plate for Ex-safety switches 20 A 3-pole | | | |
| Size 2 | Wall mounting | snap on | GHG 610 1953 R0104 |
| Size 2 | Pipe clamp | snap on | GHG 610 1953 R0105 |
| Size 2 | Trellis-work mounting | snap on | GHG 610 1953 R0106 |

| Type | Application | Fixing method | Order No. |
|--|-----------------------|---------------|--------------------|
| Mounting plate for Ex-safety switches 20 A 6-pole | | | |
| Size 3 | Wall mounting | snap on | GHG 610 1953 R0118 |
| Size 3 | Pipe clamp | snap on | GHG 610 1953 R0110 |
| Size 3 | Trellis-work mounting | snap on | GHG 610 1953 R0118 |

| Type | OU | Order No. |
|------|----|-----------|
|------|----|-----------|

Accessories for mounting plates

| | | |
|--|----|--------------------|
| Label holder with type label (blank) for mounting plate size 1, 2, 2A and 3 | 10 | GHG 610 1953 R0057 |
| Mounting set for pipes 1" (of 27 - 30 mm) for mounting plates with pipe fixing | 10 | GHG 610 1953 R0020 |

| Type | Application | OU | Order No. |
|------|-------------|----|-----------|
|------|-------------|----|-----------|

Canopies

| | | | |
|---------|---|---|--------------------|
| Size 2 | for mounting plate size 2 | 1 | GHG 610 1955 R0102 |
| Size 2A | for mounting plate size 2A | 1 | GHG 610 1955 R0103 |
| Size 3 | for pipe mounting plate size 3 vertical | 1 | GHG 610 1955 R0104 |
| Size 3A | for mounting plates wall/trellis fixing size 3 vertical | 1 | GHG 610 1955 R0105 |
| Size 3B | for mounting plates pipe fixing size 3 horizontal | 1 | GHG 610 1955 R0106 |

Please pay attention that only order units (OU) according to the ordering details can be delivered.



6-pole EMERGENCY STOP



6-pole



3-pole EMERGENCY STOP



3-pole

Dimension drawing

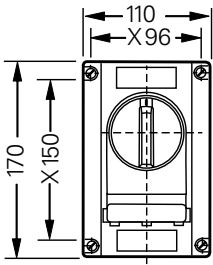

3/4-pole

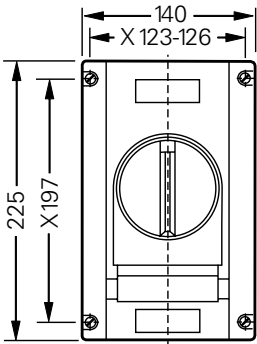
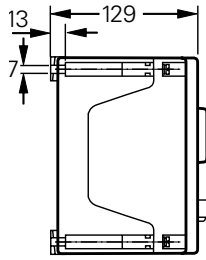

6-pole

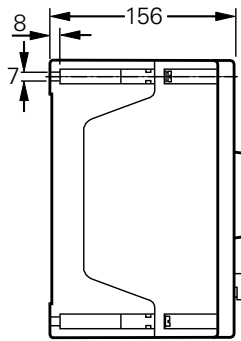

X = fixing dimensions

GHG 263 - Ex-safety switches 40 A



3-pole



3-pole EMERGENCY STOP



6-pole



6-pole EMERGENCY STOP

Technical data

Ex-safety switches 40 A

| | | |
|---|--|--------------------------------|
| Marking accd. to 2014/34/EU | Ⓔ II 2 G Ex ed ia IIC T6 / Ⓔ II 2 D Ex tD A21 IP66 T80 °C | |
| EC-Type Examination Certificate | PTB 99 ATEX 1161 | |
| IECEx Certificate of Conformity | BKI 07.0012 | |
| Marking accd. to IECEx | Ex ed ia IIC T6 Ex tD A21 IP66 T53 °C | |
| Permissible ambient temperature | -20 °C up to +40 °C ¹⁾ | |
| Rated voltage | up to max. 690 V | |
| Rated current | max. 40 A | |
| Frequency | 50/60 Hz | |
| Rated making/breaking capacity AC-3 accd. EN 60947-3 | U _b 230 V / I _b 40 A U _b 400 V / I _b 40 A U _b 500 V / I _b 40 A U _b 690 V / I _b 32 A | |
| Rated making-/ breaking capacity DC 1/DC 23 accd. EN 60947-3 | U _b 60 V / I _b 40 A (1 contact) U _b 120 V / I _b 40 A (2 contacts in series) | |
| Switch-disconnector for maintenance accd. to IEC 62262-1 | Class 1 | |
| Back-up fuse | up to 400 V AC: 80 A gG up to 500 V AC: 80 A gG up to 690 V AC: 63 A gG | |
| Connecting terminals | main contact | 2 x 16 mm ² |
| | auxiliary/signal contact | 2 x 4 mm ² (option) |
| Protection class | I | |
| Degree of protection accd. to EN 60529 | IP66 | |
| Cable glands/enclosure drilling | M25 cable gland see ordering details M40 cable gland see ordering details Option: metal flange with thread | |
| Weight | 3-pole | approx. 2.30 kg |
| | 4-pole | approx. 2.75 kg |
| | 6-pole | approx. 6.50 kg |
| Enclosure material | glass-fibre reinforced polyester | |
| Enclosure colour | black | |
| Auxiliary contact (option) | 1 x NO making - lagging; breaking - leading 1 x NC (only 6-pole version) making - leading; breaking - lagging | |
| Padlocking facility | can be locked in OFF position with 3 commercially available padlocks (Ø max. 6 mm) | |

¹⁾ Other ambient temperatures on request



6-pole EMERGENCY STOP



6-pole



3-pole EMERGENCY STOP



3-pole

Ordering details

| Content | Cable gland | Auxiliary contact | Order No. |
|----------------------------------|-------------------|-------------------|--------------------|
| Safety switch 40 A 3-pole | | | |
| 3-pole | 2 x M40 / 1 x M25 | 1 NO | GHG 263 2301 R0001 |
| 3-pole | 2 x M40 | none | GHG 263 2303 R0001 |
| 3-pole EMERGENCY STOP | 2 x M40 / 1 x M25 | 1 NO | GHG 263 2301 R0002 |
| 3-pole EMERGENCY STOP | 2 x M40 | none | GHG 263 2303 R0002 |
| Safety switch 40 A 4-pole | | | |
| 4-pole | 2 x M25 | 1 NO + 1 NC | GHG 263 2301 R0007 |
| 4-pole | 2 x M25 | none | GHG 263 2303 R0003 |
| 4-pole | 2x M40 / 1 x M25 | 1 NO + 1 NC | GHG 263 2301 R0009 |
| 4-pole | 2x M40 | none | GHG 263 2303 R0004 |
| Safety switch 40 A 6-pole | | | |
| 6-pole | 4 x M40 / 1 x M25 | 1 NO + 1 NC | GHG 263 0050 R0001 |
| 6-pole | 4 x M25 | 1 NO + 1 NC | GHG 263 0050 R0006 |
| 6-pole EMERGENCY STOP | 4 x M40 / 1 x M25 | 1 NO + 1 NC | GHG 263 0050 R0002 |

Customized version on request, auxiliary contacts in Ex ia available

Accessories

| Type | Application | Fixing method | Order No. |
|--|-----------------------|---------------|--------------------|
| Mounting plate for Ex-safety switches 40 A 3-pole | | | |
| Size 3 | Wall mounting | snap on | GHG 610 1953 R0118 |
| Size 3 | Pipe clamp | snap on | GHG 610 1953 R0110 |
| Size 3 | Trellis-work mounting | snap on | GHG 610 1953 R0118 |

| Type | Application | Fixing method | Order No. |
|--|----------------|------------------------|--------------------|
| Mounting plate for Ex-safety switches 40 A 6-pole | | | |
| Size 3 | 2 x pipe clamp | screw-on ¹⁾ | GHG 610 1953 R0110 |

¹⁾ observe mounting distance

| Type | Application | OU | Order No. |
|--|-------------|----|--------------------|
| Accessories for mounting plates | | | |
| Label for label holder and mounting plates size 4 and size 5 | | 10 | GHG 610 1953 R0011 |
| Blind plug for mounting plate size 4 and size 5 1 set = 1 pcs. | | 10 | GHG 610 1953 R0134 |
| Plug-in fastener for CEAG modules with 5.5 mm and 11 mm mounting feet 1 set = 4 pcs. | | 10 | GHG 610 1953 R0041 |
| Mounting set for pipes 1" (of 27 - 30 mm) for mounting plates with pipe fixing | | 10 | GHG 610 1953 R0020 |

| Type | Application | OU | Order No. |
|-----------------|---------------------------|----|--------------------|
| Canopies | | | |
| Size 4 | for mounting plate size 4 | 1 | GHG 610 1955 R0107 |

Please pay attention that only order units (OU) according to the ordering details can be delivered.

GHG 263 - Ex-safety switches 40 A



3-pole



3-pole EMERGENCY STOP



6-pole



6-pole EMERGENCY STOP

Dimension drawing

5

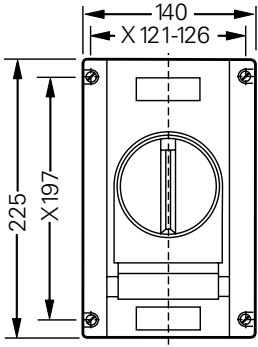

3/4-pole

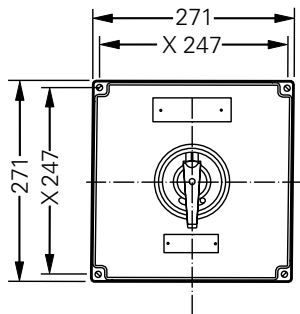
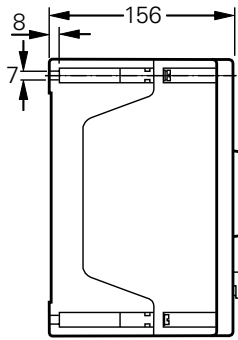

6-pole

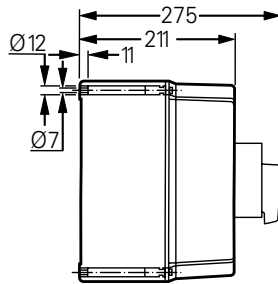

X = fixing dimensions

Dimensions in mm



6-pole EMERGENCY STOP



6-pole



3/4-pole EMERGENCY STOP



3/4-pole

Technical data

Ex-safety switches 80 A

| | | |
|---|--|--------------------------------|
| Marking accd. to 2014/34/EU | Ⓔ II 2 G Ex db e [ia/ib] IIB/IIC T5/T6 Gb / Ⓔ II 2 D Ex tb IIIC T80 °C Db | |
| EC-Type Examination Certificate | BVS 15 ATEX E 125 X | |
| IECEX Certificate of Conformity | IECEX BVS 15.0103X | |
| Marking accd. to IECEx | Ex db e [ia/ib] IIB/IIC T5/T6 Gb Ex tb III C T80°C Db | |
| Permissible ambient temperature | -20 °C up to +40 °C ¹⁾ | |
| Rated voltage | up to max. 690 V | |
| Rated current | max. 80 A | |
| Frequency | 50/60 Hz | |
| Rated making/breaking capacity AC-3 accd. EN 60947-3 | U _e 230 V / I _e 80 A U _e 400 V / I _e 80 A U _e 500 V / I _e 80 A U _e 690 V / I _e 63 A | |
| Rated making-/ breaking capacity DC 1/DC 23 accd. EN 60947-3 | U _e 60 V / I _e 80 A (1 contact) U _e 120 V / I _e 80 A (2 contacts in series) | |
| Switch-disconnector for maintenance accd. to IEC 62262-1 | Class 1 | |
| Back-up fuse | up to 400 V AC: 160 A gG up to 500 V AC: 160 A gG up to 690 V AC: 125 A gG | |
| Connecting terminals | main contact | 2 x 25 mm ² |
| | auxiliary/signal contact | 2 x 4 mm ² (option) |
| Protection class | I | |
| Degree of protection accd. to EN 60529 | IP66 | |
| Cable glands/enclosure drilling | M25 cable gland see ordering details M32 cable gland see ordering details M50 cable gland see ordering details Option: metal flange with thread | |
| Weight | 3/4-pole | approx. 6.5 kg |
| | 6-pole | approx. 9.0 kg |
| Enclosure material | glass-fibre reinforced polyester | |
| Enclosure colour | black | |
| Auxiliary contact (option) | 1 x NO making - lagging; breaking - leading 1 x NC making - leading; breaking - lagging | |
| Padlocking facility | can be locked in OFF position with 3 commercially available padlocks (Ø max. 6 mm) | |

¹⁾ Other ambient temperatures on request

GHG 264 - Ex-safety switches 80 A



3/4-pole



3/4-pole EMERGENCY STOP



6-pole



6-pole EMERGENCY STOP

Ordering details

5

| Content | Cable gland | Auxiliary contact | Order No. |
|----------------------------------|-------------------|-------------------|---------------------------|
| Safety switch 80 A 3-pole | | | |
| 3-pole | 2 x M50 / 1 x M25 | 1 NO + 1 NC | GHG 264 0020 R0001 |
| 3-pole | 2 x M50 | none | GHG 264 0025 R0001 |
| 3-pole EMERGENCY STOP | 2 x M50 / 1 x M25 | 1 NO + 1 NC | GHG 264 0020 R0002 |
| 3-pole EMERGENCY STOP | 2 x M50 | none | GHG 264 0025 R0002 |
| Safety switch 80 A 4-pole | | | |
| 4-pole | 2 x M50 / 1 x M25 | 1 NO + 1 NC | GHG 264 0020 R0012 |
| 4-pole | 2 x M50 | none | GHG 264 0025 R0004 |
| 4-pole | 2 x M32 | 1 NO + 1 NC | GHG 264 0020 R0006 |
| 4-pole | 2 x M32 | none | GHG 264 0025 R0003 |
| Safety switch 80 A 6-pole | | | |
| 6-pole | 4 x M50 / 1 x M25 | 1 NO + 1 NC | GHG 264 0021 R0001 |
| 6-pole EMERGENCY STOP | 4 x M50 / 1 x M25 | 1 NO + 1 NC | GHG 264 0021 R0002 |

Customized version on request, auxiliary contacts in Ex ia available

Accessories

| Type | Application | Fixing method | Order No. |
|--|----------------|------------------------|---------------------------|
| Mounting plate for Ex-safety switches 80 A 3/4- and 6-pole | | | |
| Size 3 | 2 x pipe clamp | screw-on ¹⁾ | GHG 610 1953 R0110 |
| ¹⁾ observe mounting distance | | | |
| Type | | OU | Order No. |
| Accessories for mounting plates | | | |
| Type label for label holder and mounting plates size 4 and size 5 | | 10 | GHG 610 1953 R0011 |
| Mounting set for pipes 1" (of 27 - 30 mm) for mounting plates with pipe fixing | | 10 | GHG 610 1953 R0020 |

Please pay attention that only order units (OU) according to the ordering details can be delivered.

Dimension drawing

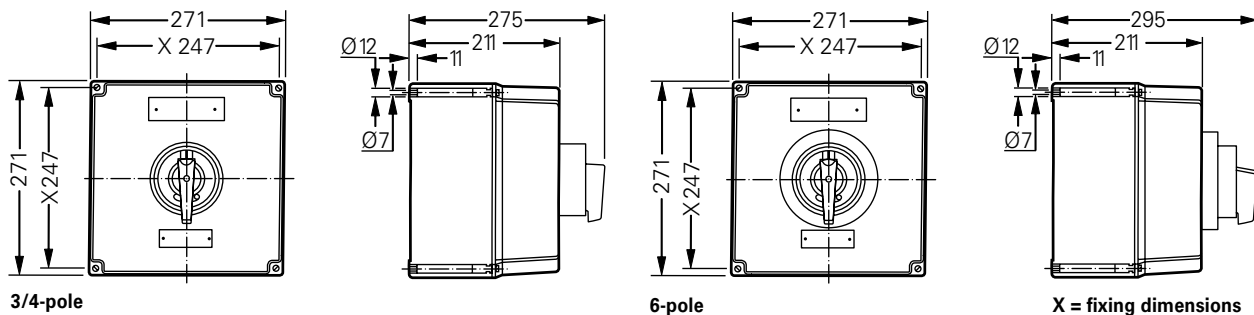

Dimensions in mm



6-pole EMERGENCY STOP



6-pole



3/4-pole EMERGENCY STOP



3/4-pole

Technical data

Ex-safety switches 125 A

| | | |
|--|--|---|
| Marking accd. to 2014/34/EU | Ⓢ II 2 G Ex db eb ia IIC/IIB/IIB+H2 T6/T5 Gb Ⓢ II 2 D Ex tb IIIC T80°C Db | |
| EC-Type Examination Certificate | BVS 22 ATEX E 018 X | |
| IECEx Certificate of Conformity | IECEx BVS 22.0019X | |
| Marking accd. to IECEx | Ex db eb ia IIC/IIB/IIB+H2 T6/T5 Gb Ex tb IIIC T80°C Db | |
| Permissible ambient temperature | -55 °C up to +55 °C (IIB/IIB+H2/IIIC) / -55 °C up to +55 °C (IIC) | |
| Rated voltage | up to max. 690 V | |
| Frequency | 50/60 Hz | |
| Rated making/breaking capacity AC-3 accd. EN 60947-3 | U _e 230 V / I _e 125 A U _e 400 V / I _e 125 A U _e 500 V / I _e 125 A U _e 690 V / I _e 110 A | |
| Switch-disconnector for maintenance accd. to IEC 62262-1 | Class 1 | |
| Back-up fuse | up to 400 V AC: 200 A gG up to 500 V AC: 200 A gG up to 690 V AC: 160 A gG | |
| Connecting terminals | main contact 3/4-pole 6-pole auxiliary/signal contact | 1 x 50/70 mm ² 6 x 95 mm ² /2 x 95 mm ² 2 x 4 mm ² (option) |
| Protection class | I | |
| Degree of protection accd. to EN 60529 | IP66 | |
| Cable glands/enclosure drilling | M25 cable gland see ordering details M40 cable gland see ordering details M63 cable gland see ordering details Option: metal flange with 2 x thread | |
| Weight | 3/4-pole 6-pole | approx. 16 kg approx. 31 kg |
| Enclosure material | 3/4-pole 6-pole | glass-fibre reinforced polyester sheet steel polyester powder coated |
| Enclosure colour | 3/4-pole 6-pole | RAL 7032 black |
| Auxiliary contact (option) | 1 x NO making - lagging; breaking - leading 1 x NC making - leading; breaking - lagging | |
| Padlocking facility | can be locked in OFF position with 3 commercially available padlocks (Ø max. 6 mm) | |

¹⁾ Other ambient temperatures on request

GHG 265 / EXKO 2 - Ex-safety switches 125 A



3/4-pole



3/4-pole EMERGENCY STOP



6-pole



6-pole EMERGENCY STOP

Ordering details

5

| Content | Cable gland | Auxiliary contact | Order No. |
|-----------------------------------|-------------------|-------------------|---------------------------|
| Safety switch 125 A 3-pole | | | |
| 3-pole | 2 x M63 / 1 x M25 | 1 NO + 1 NC | GHG 265 0010 R0001 |
| 3-pole | 2 x M63 | none | GHG 265 0015 R0001 |
| 3-pole EMERGENCY STOP | 2 x M63 / 1 x M25 | 1 NO + 1 NC | GHG 265 0010 R0002 |
| 3-pole EMERGENCY STOP | 2 x M63 | none | GHG 265 0015 R0002 |
| Safety switch 125 A 4-pole | | | |
| 4-pole | 2 x M40 | 1 NO + 1 NC | GHG 265 0010 R0005 |
| 4-pole | 2 x M63 | none | GHG 265 0015 R0003 |
| Safety switch 125 A 6-pole | | | |
| 6-pole | 4 x M63 / 1 x M25 | 1 NO + 1 NC | EXKO 224716 K 0000 |
| 6-pole EMERGENCY STOP | 4 x M63 / 1 x M25 | 1 NO + 1 NC | EXKO 224726 K 0000 |

Customized version on request, auxiliary contacts in Ex ia available

Accessories

| Type | Application | Fixing method | Order No. |
|--|----------------|------------------------|---------------------------|
| Mounting plate for Ex-safety switches 125 A 3/4-pole²⁾ | | | |
| Size 3 | 2 x pipe clamp | screw-on ¹⁾ | GHG 610 1953 R0110 |

¹⁾ observe mounting distance

²⁾ 2 pcs. necessary for mounting

| Type | OU | Order No. |
|--|----|---------------------------|
| Accessories for mounting plates | | |
| Label holder with type label (blank) for mounting plate size 1, 2, 2A and 3 | 10 | GHG 610 1953 R0057 |
| Mounting set for pipes 1" (of 27 - 30 mm) for mounting plates with pipe fixing | 10 | GHG 610 1953 R0020 |

Please pay attention that only order units (OU) according to the ordering details can be delivered.



6-pole EMERGENCY STOP



6-pole



3/4-pole EMERGENCY STOP



3/4-pole

Dimension drawing

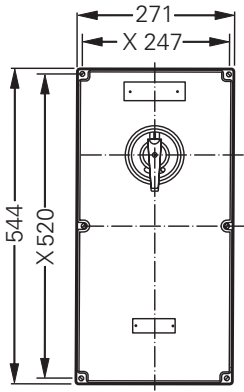

3/4-pole

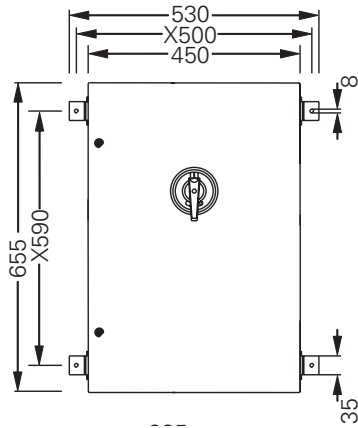
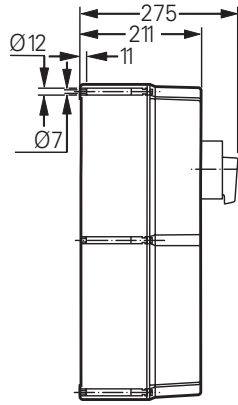

6-pole

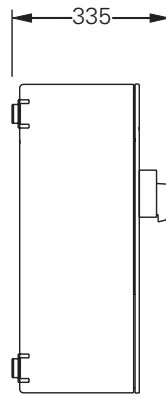

X = fixing dimensions