

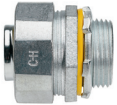







# Liquidtight fittings

## Overview

Our liquidtight product line offers high quality, high performance fittings. Designed to the toughest standards and integrating the latest technology, not only do you get a reliable and durable product, you also get one that reduces installation time and cost. Our versatile lines of liquidtight fittings are designed for a wide range of industrial, commercial and residential applications. Choose from our Liquidator™, LiQuik™, zinc die cast, non-metallic or low profile liquidtight fittings.

### Liquidtight fittings selection chart:

	Family	Material	Size/range	Configurations	Typical applications
	<b>Liquidator™</b>	Malleable iron	3/8" - 6"	Straight, 45°, 90°	For use with LFMC in tough, industrial, corrosive applications
	<b>Liquidator LT SA aluminum</b>	Copper-free aluminum	3/8" - 4"	Straight (3/8" through 4"), 90° (3/8" through 2")	Used where aluminum material is preferred in tough, industrial, corrosive applications
	<b>LTK low profile</b>	Steel/malleable iron	3/8" - 2"	Straight, 45°, 90°	Used where there are space restrictions in tough, industrial, corrosive applications
	<b>LTQ LiQuik™</b>	Malleable iron	3/8" - 2"	Straight	Labor saving, no disassembly, in tough, industrial, corrosive applications
	<b>LTDC zinc die cast</b>	Zinc die cast	3/8" - 4"	Straight, 90°	Used where zinc die cast material is preferred in tough, industrial, corrosive applications
	<b>LTNM non-metallic</b>	Nylon	3/8" - 2"	Straight, 90°	Use with non-metallic Type B LT conduit in corrosive, commercial and residential applications
	<b>LTS steel</b>	Tubular steel	1/2" - 2"	Straight only	For use in cost-competitive applications in light industrial and commercial applications
	<b>LT SS stainless Steel</b>	304 stainless steel	1/2" - 2"	Straight, 90°	Used where corrosion resistance is required in tough, industrial, corrosive applications

Liquidtight

Product features	User benefits
UL Listed; cUL certified	Assurance of safe and reliable performance; end-user peace of mind
Provides protection in wet locations	Meets NEC and UL requirements for use in wet locations; reduces downtime and replacement costs
Available in various configurations in various trade sizes and materials	Complete selection of styles and sizes; easy selection from one source, saves time and money
Hex surfaces on gland nut and body	Easy wrenching; fast, easy installation results in labor savings
Sealing gasket effectively seals out water, oil, dust and dirt	Eliminates leakage, potential downtime and replacement costs
Locknut bites into box; won't vibrate loose	Provides a reliable ground and safety of personnel and equipment
Cupped long grounding ferrule is distortion-free	Provides excellent pull-out strength, prevents conduit pop-out and provides grounding for safety of personnel and equipment
Concrete tight	Provides rugged durability in concrete applications

# Liquidtight fittings

## Overview

### Applications:

Typical applications for liquidtight conduit and liquidtight fittings include the wiring of machine tools, motors, transformers, food processing equipment, robotics, air conditioning units, illuminated storefront signs and billboards, etc. The flexible metallic conduit and fittings protect conductors from mechanical damage due to vibration and movement, and seal out cutting oils, coolants, water, dust, etc. Applications such as these can be found in, but are not limited to, industries such as:

- Machine tool manufacturers
- Electric power generating plants
- Waste treatment facilities
- Paint manufacturing facilities
- Automobile manufacturing facilities
- Aerospace industries
- Breweries
- Food processing plants
- Dairies
- Pulp and paper mills
- Petroleum refineries
- Chemical and petrochemical plants
- Healthcare

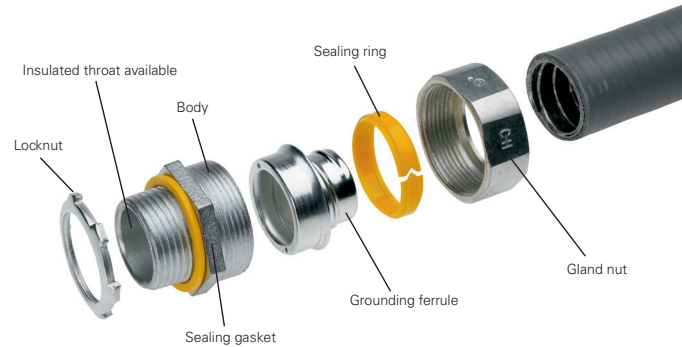

### Features:

- Liquidtight, raintight, oiltight for protection and long life in wet, dusty and corrosive environments
- Hex shaped gland nut allows for easy wrenching, providing a fast, tight installation
- Suitable for wet locations
- Reusable, long ferrule prevents pull-out and tight bend conduit pop-out
- Furnished with locknut and sealing ring
- Third party certified
- Available in insulated and non-insulated versions to meet any customer preference

### Certifications and compliances:

- UL Listed liquidtight flexible metal conduit fittings are suitable for use in the following hazardous locations under NEC:
  - Class I, Division 2;
  - Class II, Divisions 1 & 2; and
  - Class III, Divisions 1 & 2;
  - Suitable for grounding in sizes  $\frac{3}{8}$ " through  $1\frac{1}{4}$ " under NEC
- UL Standards 514B, 467
- cUL Standard C22.2 No. 18F
- UL File No. E-19189



# Liquidtight fittings

## Liquidator™ flexible metallic conduit fittings

### Applications:

- Liquidator™ fittings are used when liquidtight conduit is in tough, industrial and corrosive applications
- Available in both malleable iron and aluminum construction with the option of a ground lug pre-attached

### Features:

- Liquidtight, raintight, oiltight for protection and long life in wet, dusty and corrosive environments
- Hex shaped gland nut allows for easy wrenching, providing a fast, tight installation
- Suitable for wet locations
- Reusable, long ferrule prevents pull-out and tight bend conduit pop-out
- Furnished with locknut and sealing ring
- Third party certified
- Available in malleable iron and aluminum construction
- Available in straight, 90 and 45 degree configurations
- Available in sizes 3/8" to 6" (select sizes)
- Available in insulated and non-insulated versions to meet any customer preference

### Certifications and compliances:

- UL Listed liquidtight flexible metal conduit fittings are suitable for use in the following hazardous locations under NEC:
  - Class I, Division 2;
  - Class II, Divisions 1 & 2; and
  - Class III, Divisions 1 & 2;
  - Suitable for grounding in sizes 3/8" through 1 1/4" under NEC
- UL Standards 514B, 467
- cUL Standard C22.2 No. 18F
- UL File No. E-19189

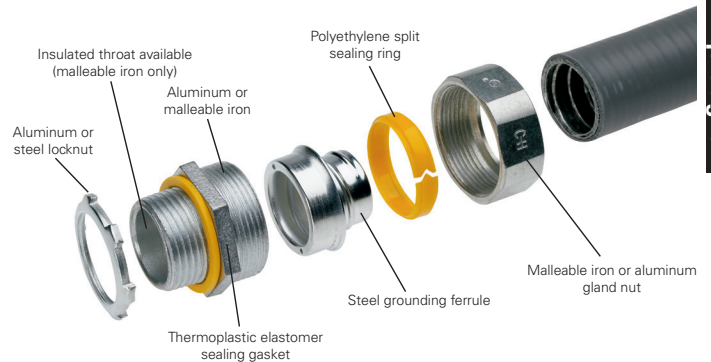

Liquidtight

### Standard materials:

- Body – straight – 3/8" through 6": malleable iron; 3/8" through 4": aluminum
- 45° – 3/8" through 4": malleable iron
- 90° – 3/8" through 4": malleable iron or aluminum
- Gland nut – malleable iron or aluminum
- Ferrule – steel
- Gland nut sealing ring – polyethylene
- Sealing gasket – thermoplastic elastomer
- Locknut – steel or aluminum

### Standard finishes:

- Malleable iron – zinc electroplate
- Aluminum – natural

# Liquidtight fittings

## Liquidator™ flexible metallic conduit fittings

### Straight connectors – malleable iron

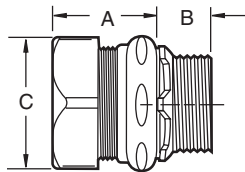
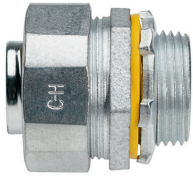

Trade size	Cat. # Non-insulated	Cat. # Insulated	Unit qty.	Wt. lbs. per 100	A	B	C
3/8"	LT38	LTB38	25	15.4	1.125	0.500	1.125
1/2"	LT50	LTB50	25	17.6	1.250	0.500	1.250
3/4"	LT75	LTB75	25	28.7	1.250	0.500	1.563
1"	LT100	LTB100	5	39.7	1.438	0.625	0.813
1 1/4"	LT125	LTB125	5	55.1	1.500	0.688	2.250
1 1/2"	LT150	LTB150	2	70.5	1.625	0.750	2.438
2"	LT200	LTB200	1	99.2	1.750	0.750	3.000
2 1/2"	LT250	LTB250	1	363.8	2.188	1.000	4.000
3"	LT300	LTB300	1	456.4	2.500	1.125	4.188
3 1/2"	LT350	LTB350	1	668.0	2.625	1.188	5.250
4"	LT400	LTB400	1	789.2	2.750	1.250	5.750
5"	LT500 <sup>Ⓢ</sup>	LTB500 <sup>Ⓢ</sup>	1	1036.2	3.125	1.438	6.063
6"	LT600 <sup>Ⓢ</sup>	LTB600 <sup>Ⓢ</sup>	1	1366.9	3.375	1.500	7.750

<sup>Ⓢ</sup> Not UL Listed or CSA certified.

Liquidtight

### Straight connectors with grounding lug – malleable iron

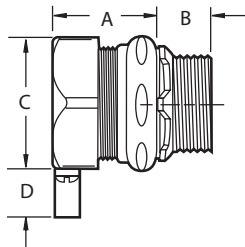

Trade size	Cat. # Non-insulated with aluminum grounding lug	Cat. # Insulated with aluminum grounding lug	Cat. # insulated with copper grounding lug	Lug size	Unit qty.	Wt. lbs. per 100	A	B	C	D
3/8"	LT38G	LTB38G	LTB38GC	#4 - #14	25	17.4	1.125	0.500	1.125	0.750
1/2"	LT50G	LTB50G	LTB50GC	#4 - #14	25	19.5	1.250	0.500	1.250	0.750
3/4"	LT75G	LTB75G	LTB75GC	#4 - #14	25	30.7	1.250	0.500	1.563	0.750
1"	LT100G	LTB100G	LTB100GC	#4 - #14	5	41.7	1.438	0.625	0.813	0.750
1 1/4"	LT125G	LTB125G	LTB125GC	#4 - #14	5	57.0	1.500	0.688	2.250	0.750
1 1/2"	LT150G	LTB150G	LTB150GC	#4 - #14	2	72.4	1.625	0.750	2.438	0.750
2"	LT200G	LTB200G	LTB200GC	#4 - #14	1	100.9	1.750	0.750	3.000	0.750
2 1/2"	LT250G	LTB250G	LTB250GC	#1/0 - #8	1	370.9	2.188	1.000	4.000	1.125
3"	LT300G	LTB300G	LTB300GC	#1/0 - #8	1	462.9	2.500	1.125	4.188	1.125
3 1/2"	LT350G	LTB350G	LTB350GC	#3/0 - #6	1	682.1	2.625	1.188	5.250	1.500
4"	LT400G	LTB400G	LTB400GC	#3/0 - #6	1	802.9	2.750	1.250	5.750	1.500
5"	LT500G <sup>Ⓢ</sup>	LTB500G <sup>Ⓢ</sup>	-	250MCM - #6	1	1052.7	3.125	1.438	6.063	1.688
6"	LT600G <sup>Ⓢ</sup>	LTB600G <sup>Ⓢ</sup>	-	250MCM - #6	1	1389.4	3.375	1.500	7.750	1.688

<sup>Ⓢ</sup> Not UL Listed or CSA certified.

### Straight connectors with and without grounding lug – aluminum

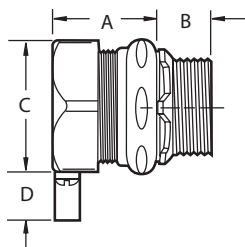
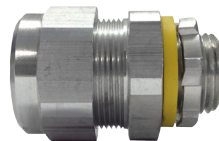

Trade size	Cat. # Non-insulated	Cat. # Non-insulated with aluminum grounding lug	Lug size	Unit qty.	Wt. lbs. per 100	A	B	C	D
3/8"	LT38 SA	LT38G SA	#4 - #14	25	13.4	1.188	0.594	1.250	0.750
1/2"	LT50 SA	LT50G SA	#4 - #14	25	15.6	1.313	0.594	1.250	0.750
3/4"	LT75 SA	LT75G SA	#4 - #14	25	26.7	1.313	0.594	1.500	0.750
1"	LT100 SA	LT100G SA	#4 - #14	5	37.7	1.438	0.813	1.750	0.750
1 1/4"	LT125 SA	LT125G SA	#4 - #14	5	53.1	1.563	0.813	2.250	0.750
1 1/2"	LT150 SA	LT150G SA	#4 - #14	2	68.5	1.813	0.813	2.500	0.750
2"	LT200 SA	LT200G SA	#4 - #14	1	97.2	1.750	0.875	3.000	0.750
2 1/2"	LT250 SA	LT250G SA	#1/0 - #8	1	361.8	2.250	1.063	3.750	1.125
3"	LT300 SA	LT300G SA	#1/0 - #8	1	454.4	2.438	1.125	4.500	1.125
3 1/2"	LT350 SA	LT350G SA	#3/0 - #6	1	666.0	2.875	1.188	5.125	1.500
4"	LT400 SA	LT400G SA	#3/0 - #6	1	787.2	2.938	1.250	5.625	1.500

# Liquidtight fittings

## Liquidator™ liquidtight flexible metallic conduit fittings

### 90° angle connectors – malleable iron

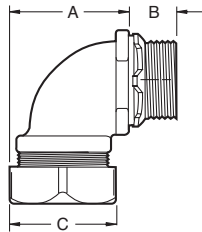

Trade size	Cat. # Non-insulated	Cat. # Insulated	Unit qty.	Wt. lbs. per 100	A	B	C
3/8"	LT3890	LTB3890	25	25.4	1.313	0.500	1.125
1/2"	LT5090	LTB5090	25	28.9	1.438	0.500	1.250
3/4"	LT7590	LTB7590	10	44.1	1.625	0.500	1.563
1"	LT10090	LTB10090	10	74.5	2.313	0.625	0.813
1 1/4"	LT12590	LTB12590	5	96.1	2.375	0.688	2.250
1 1/2"	LT15090	LTB15090	2	121.3	3.063	0.750	2.438
2"	LT20090	LTB20090	1	176.4	3.188	0.750	3.000
2 1/2"	LT25090	LTB25090	1	837.7	8.313	1.000	4.000
3"	LT30090	LTB30090	1	1234.6	9.813	1.125	4.188
3 1/2"	LT35090	LTB35090	1	1896.0	11.188	1.188	5.250
4"	LT40090	LTB40090	1	2381.0	12.563	1.250	5.750

### 90° angle connectors with grounding lug – malleable iron

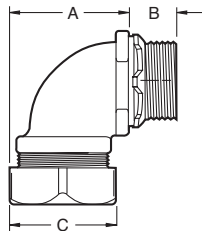

Trade size	Cat. # Non-insulated with aluminum grounding lug	Cat. # Insulated with aluminum grounding lug	Cat. # Insulated with copper grounding lug	Lug size	Unit qty.	Wt. lbs. per 100	A	B	C
3/8"	LT3890G	LTB3890G	LTB3890GC	#4 - #14	25	27.6	1.313	0.500	1.125
1/2"	LT5090G	LTB5090G	LTB5090GC	#4 - #14	25	31.1	1.438	0.500	1.250
3/4"	LT7590G	LTB7590G	LTB7590GC	#4 - #14	10	46.3	1.625	0.500	1.563
1"	LT10090G	LTB10090G	LTB10090GC	#4 - #14	10	76.7	2.313	0.625	0.813
1 1/4"	LT12590G	LTB12590G	LTB12590GC	#4 - #14	5	98.3	2.375	0.688	2.250
1 1/2"	LT15090G	LTB15090G	LTB15090GC	#4 - #14	2	123.5	3.063	0.750	2.438
2"	LT20090G	LTB20090G	LTB20090GC	#4 - #14	1	178.6	3.188	0.750	3.000
2 1/2"	LT25090G	LTB25090G	LTB25090GC	#1/0 - #8	1	846.6	8.313	1.000	4.000
3"	LT30090G	LTB30090G	LTB30090GC	#1/0 - #8	1	1243.4	9.813	1.125	4.188
3 1/2"	LT35090G	LTB35090G	LTB35090GC	#3/0 - #6	1	1913.6	11.188	1.188	5.250
4"	LT40090G	LTB40090G	LTB40090GC	#3/0 - #6	1	2398.6	12.563	1.250	5.750

### 90° angle connectors with and without grounding lug – aluminum

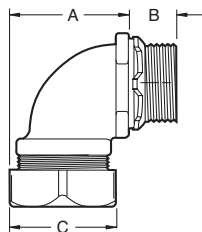

Trade size	Cat. # Non-insulated	Cat. # Non-insulated with aluminum grounding lug	Lug size	Unit qty.	Wt. lbs. per 100	A	B	C
3/8"	LT3890 SA	LT3890G SA	#4 - #14	25	16	1.313	0.500	1.125
1/2"	LT5090 SA	LT5090G SA	#4 - #14	25	20	1.438	0.500	1.250
3/4"	LT7590 SA	LT7590G SA	#4 - #14	10	25	1.625	0.500	1.563
1"	LT10090 SA	LT10090G SA	#4 - #14	10	31	2.313	0.625	0.813
1 1/4"	LT12590 SA	LT12590G SA	#4 - #14	5	48	2.375	0.688	2.250
1 1/2"	LT15090 SA	LT15090G SA	#4 - #14	2	150	3.063	0.750	2.438
2"	LT20090 SA	LT20090G SA	#4 - #14	1	200	3.188	0.750	3.000

Liquidtight

# Liquidtight fittings

## Liquidator™ liquidtight flexible metallic conduit fittings

### 45° angle connectors – malleable iron

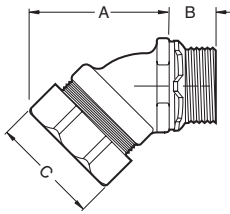

Trade size	Cat. # Non-insulated	Cat. # Insulated	Unit qty.	Wt. lbs. per 100	A	B	C
3/8"	LT3845	LTB3845	25	27.1	1.938	0.500	1.125
1/2"	LT5045	LTB5045	25	27.1	2.000	0.500	1.250
3/4"	LT7545	LTB7545	10	39.7	2.188	0.500	1.563
1"	LT10045	LTB10045	10	63.5	2.500	0.625	0.813
1 1/4"	LT12545	LTB12545	5	87.3	2.813	0.688	2.250
1 1/2"	LT15045	LTB15045	2	110.2	3.000	0.750	2.438
2"	LT20045	LTB20045	1	176.4	3.688	0.750	3.000
2 1/2"	LT25045	LTB25045	1	573.2	7.313	1.000	4.000
3"	LT30045	LTB30045	1	859.8	7.625	1.125	4.188
3 1/2"	LT35045	LTB35045	1	1278.7	9.625	1.188	5.250
4"	LT40045	LTB40045	1	1521.2	11.063	1.250	5.750

Liquidtight

### 45° angle connectors with grounding lug – malleable iron

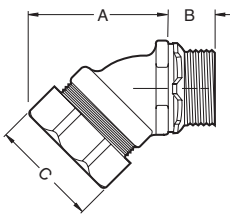

Trade size	Cat. # Non-insulated with aluminum grounding lug	Cat. # Insulated with aluminum grounding lug	Cat. # Insulated with copper grounding lug	Lug size	Unit qty.	Wt. lbs. per 100	A	B	C
3/8"	LT3845G	LTB3845G	LTB3845GC	#4 - #14	25	29.3	1.938	0.500	1.125
1/2"	LT5045G	LTB5045G	LTB5045GC	#4 - #14	25	29.3	2.000	0.500	1.250
3/4"	LT7545G	LTB7545G	LTB7545GC	#4 - #14	10	41.9	2.188	0.500	1.563
1"	LT10045G	LTB10045G	LTB10045GC	#4 - #14	10	65.7	2.500	0.625	0.813
1 1/4"	LT12545G	LTB12545G	LTB12545GC	#4 - #14	5	89.5	2.813	0.688	2.250
1 1/2"	LT15045G	LTB15045G	LTB15045GC	#4 - #14	2	112.4	3.000	0.750	2.438
2"	LT20045G	LTB20045G	LTB20045GC	#4 - #14	1	178.6	3.688	0.750	3.000
2 1/2"	LT25045G	LTB25045G	LTB25045GC	#1/0 - #8	1	582.0	7.313	1.000	4.000
3"	LT30045G	LTB30045G	LTB30045GC	#1/0 - #8	1	868.6	7.625	1.125	4.188
3 1/2"	LT35045G	LTB35045G	LTB35045GC	#3/0 - #6	1	1296.3	9.625	1.188	5.250
4"	LT40045G	LTB40045G	LTB40045GC	#3/0 - #6	1	1538.8	11.063	1.250	5.750

### Replacement liquidtight ferrules



Trade size	Cat. #	Unit qty.	Wt. lbs. per 100
3/8"	FEA38	100	1.9
1/2"	FEA50	100	2.2
3/4"	FEA75	100	2.5
1"	FEA100	100	3.1
1 1/4"	FEA125	50	5.0
1 1/2"	FEA150	50	6.3
2"	FEA200	10	8.1
2 1/2"	FEA250	10	21.3
3"	FEA300	10	27.5
3 1/2"	FEA350	10	31.3
4"	FEA400	10	34.4

# Liquidtight fittings

## LTK low profile conduit fittings

### Applications:

- Flexible metallic liquidtight conduit used with liquidtight fittings is designed to protect conductors from mechanical damage due to vibration and movement while sealing out cutting oils, coolants, water, dust, etc.
- Typical applications include the wiring of machine tools, motors, transformers, food processing equipment, robotics, air conditioning units, illuminated signs, etc.
- LTK low profile liquidtight fittings are designed specifically for OEM applications that require close side-by-side mounting of multiple liquidtight fittings in tight spaces

### Standard materials:

- Body – straight: steel  
45°: malleable iron  
90°: malleable iron
- Gland nut – steel
- Ferrule – steel
- Gland nut sealing ring – nylon
- Sealing gasket – polypropylene
- Locknut – steel

### Certifications and compliances:

- UL Listed liquidtight flexible metal conduit fittings are suitable for use in the following hazardous locations under NEC:
  - Class I, Division 2;
  - Class II, Divisions 1 & 2; and
  - Class III, Divisions 1 & 2;
  - Suitable for grounding in sizes 3/8" through 1 1/4" under NEC
- UL Standards 514B, 467
- cUL Standard C22.2 No. 18F
- UL File No. E-19189



### Standard finishes:

- Steel – zinc electroplate
- Malleable iron – zinc electroplate

Liquidtight

### Straight connectors – steel

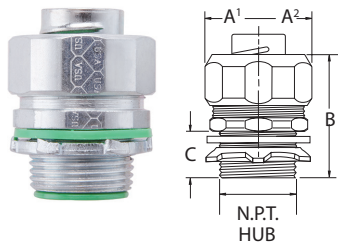

Trade size	Cat. # Non-insulated	Cat. # Insulated	Unit qty.	Wt. lbs. per 100	Over round corner A <sup>1</sup>	Hex A <sup>2</sup>	B	C
3/8"	LTK38	LTBK38	25	11	1.094	1.031	1.188	0.594
1/2"	LTK50	LTBK50	25	13	1.188	1.125	1.688	0.594
3/4"	LTK75	LTBK75	10	19	1.438	1.375	1.438	0.594
1"	LTK100	LTBK100	5	30	1.750	1.688	1.625	0.656
1 1/4"	LTK125	LTBK125	5	45	2.156	2.063	1.844	0.672
1 1/2"	LTK150	LTBK150	2	62	2.375	2.281	2.000	0.719
2"	LTK200	LTBK200	2	83	2.875	2.781	2.125	0.719

### 90° angle connectors – malleable iron

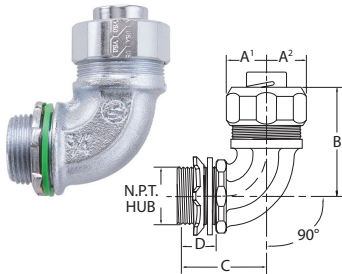

Trade size	Cat. # Non-insulated	Cat. # Insulated	Unit qty.	Wt. lbs. per 100	Over round corner A <sup>1</sup>	Hex A <sup>2</sup>	B	C	D
3/8"	LTK3890	LTBK3890	10	20	1.094	1.031	1.594	1.250	0.563
1/2"	LTK5090	LTBK5090	10	23	1.188	1.125	1.656	1.250	0.563
3/4"	LTK7590	LTBK7590	5	31	1.438	1.375	1.781	1.531	0.563
1"	LTK10090	LTBK10090	5	68	1.750	1.688	2.188	1.844	0.656
1 1/4"	LTK12590	LTBK12590	2	82	2.156	2.063	2.375	1.938	0.688
1 1/2"	LTK15090	LTBK15090	1	105	2.375	2.281	2.625	2.094	0.719
2"	LTK20090	LTBK20090	1	180	2.875	2.781	3.063	2.406	0.719

### 45° angle connectors – malleable iron

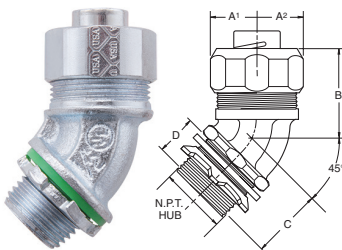

Trade size	Cat. # Non-insulated	Cat. # Insulated	Unit qty.	Wt. lbs. per 100	Over round corner A <sup>1</sup>	Hex A <sup>2</sup>	B	C	D
3/8"	LTK3845	LTBK3845	10	21	1.094	1.031	1.219	1.031	0.594
1/2"	LTK5045	LTBK5045	10	20	1.188	1.031	1.313	1.031	0.594
3/4"	LTK7545	LTBK7545	10	30	1.438	1.375	1.375	1.125	0.406
1"	LTK10045	LTBK10045	5	68	1.750	1.688	1.656	1.250	0.656
1 1/4"	LTK12545	LTBK12545	5	73	2.156	2.063	1.719	1.344	0.688
1 1/2"	LTK15045	LTBK15045	2	105	2.375	2.281	2.000	1.469	0.719
2"	LTK20045	LTBK20045	1	150	2.875	2.781	2.281	1.625	0.719

# Liquidtight fittings

## Stainless steel liquidtight accessories

### SEALING GASKETS (ORDER SEPARATELY)

#### Applications:

- To form a raintight seal between a conduit fitting and the outside of a box

#### Features:

- Gasket is designed to provide superior sealing for customer applications
- Constructed of stainless steel to provide extreme durability in the most corrosive applications

#### Certifications and compliances:

- UL Listed
- cUL Listed



#### Standard materials:

- Ring – stainless steel
- Gasket – neoprene rubber

#### Standard finishes:

- Stainless steel – natural
- Neoprene rubber – natural

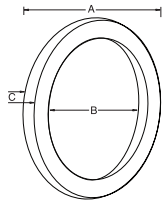

Trade size	Cat. #	Unit qty.	Wt. lbs. per 100	A	B	C
1/2"	SG1SS	50	50	1.125	0.813	0.188
3/4"	SG2SS	25	25	1.375	1.125	0.188
1"	SG3SS	25	25	1.625	1.313	0.188
1 1/4"	SG4SS	5	5	2.000	1.625	0.188
1 1/2"	SG5SS	5	5	2.250	1.875	0.188
2"	SG6SS	5	5	2.750	2.313	0.188

### LOCKNUTS (ORDER SEPARATELY)

#### Applications:

- 316 stainless steel locknuts can be used with conduit or NPS threaded pipe

#### Features:

- Precision machined threads allow for easy installation
- Heavy stock thickness and specially designed tabs tighten securely and will not easily loosen even in the most severe applications

#### Standard material:

- Locknut – stainless steel

#### Standard finish:

- Stainless steel – natural

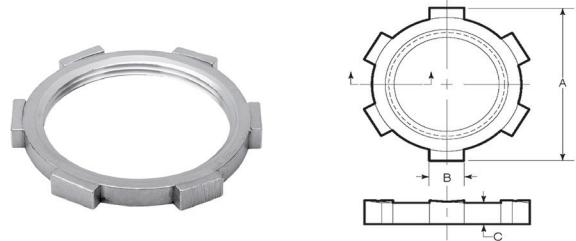

Trade size	Cat. #	Unit qty.	Wt. lbs. per 100	A	B	C	Threads/ inch
1/2"	11SS	1000	2	1.313	0.250	0.190	14.000
3/4"	12SS	500	3	1.613	0.312	0.220	14.000
1"	13SS	500	5	1.863	0.380	0.260	11.500
1 1/4"	14SS	100	7	2.250	0.380	0.260	11.500
1 1/2"	15SS	100	10	2.562	0.438	0.270	11.500
2"	16SST	100	21	3.063	0.602	0.280	11.500