

# Bussmann series EF Industrial HRC fuse links



## Product description

Eaton's Bussmann series range of British Standard C1 fuse links is specifically designed for the protection of general industrial applications e.g. power distribution, cable protection, motor protection.

## Standard features

- Good peak let-through current limitation
- 1:1:6 Selective coordination ratio between "minor" and "major" fuse
- gG characteristics for cable protection and gM for motor protection applications
- Power loss values well within the limits of IEC 60269

**EATON**

*Powering Business Worldwide*



**CHS Controls AB**

Tel +46 42 38 61 00, Fax +46 42 38 61 29  
chs@chscontrols.se www.chscontrols.se

**Catalogue symbol:**

EF(Amps)

**Technical data:**

Rated voltage: 415 V a.c. / 550 V a.c.

Rated current: 355 to 400 A

Breaking capacity: 80kA

Class of operation: gG and gM

**Standards/approvals:**

- BS88
- IEC 60269
- Suitable for use in RoHS compliant applications

**Packaging:**

- MOQ 1

**Table 1. Technical data**

Part number	Rated voltage	Rated current (Amps)	Energy integrals I <sup>2</sup> t (A <sup>2</sup> S)		Watts loss W	Product Class	Weight
			Pre-arcing	Total at 415V			
EF355	415V a.c.	355	360	865	24	gG	385g
EF400	415V a.c.	400	475	475	29	gG	385g
EF400M500	550V a.c.	400M500	1,200	2,700	27	gM	650g

**Dimensions - mm**

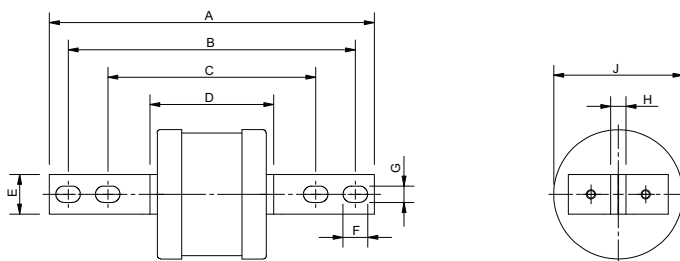

Catalogue numbers	A	B	C	D	E	F	G	H	J
EF355-400	209	184	133	50	25.4	12.5	10.5	4.7	38
EF400M500	210	184	133	75	25.4	15.5	10.5	4.7	59

Time current curve - EF355 and EF400

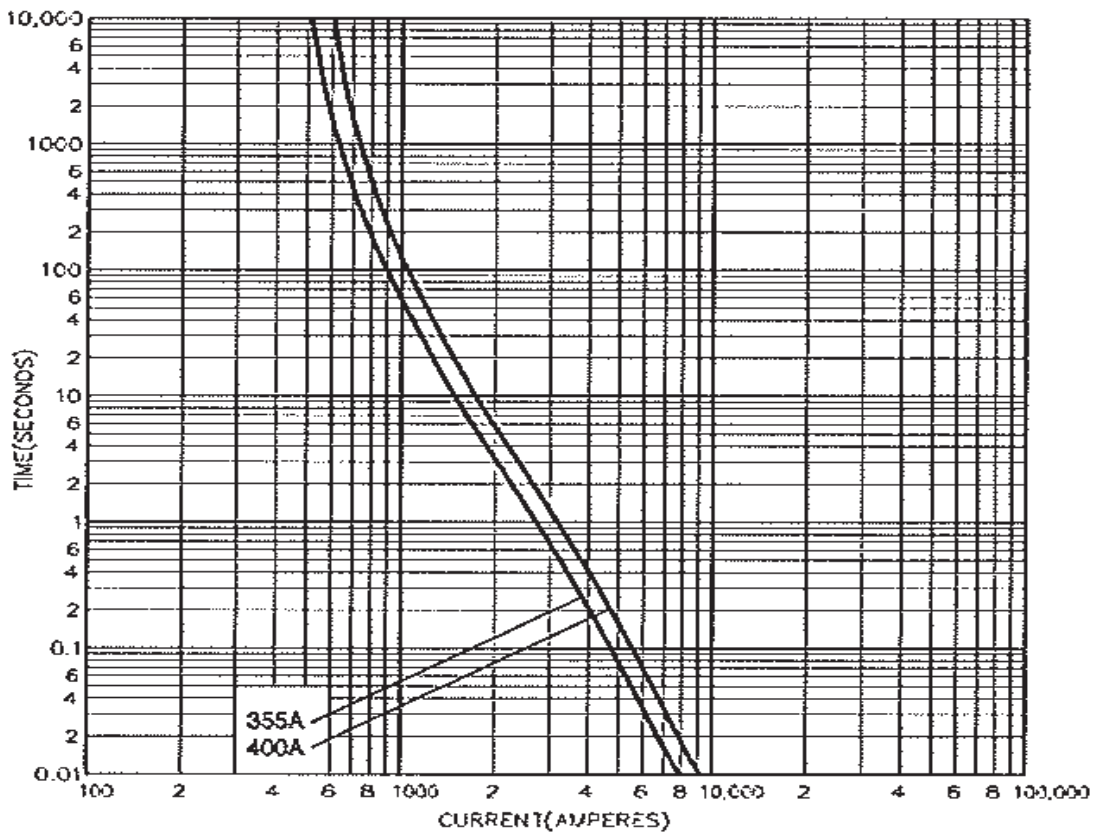

**Time current curve - EF400M500**

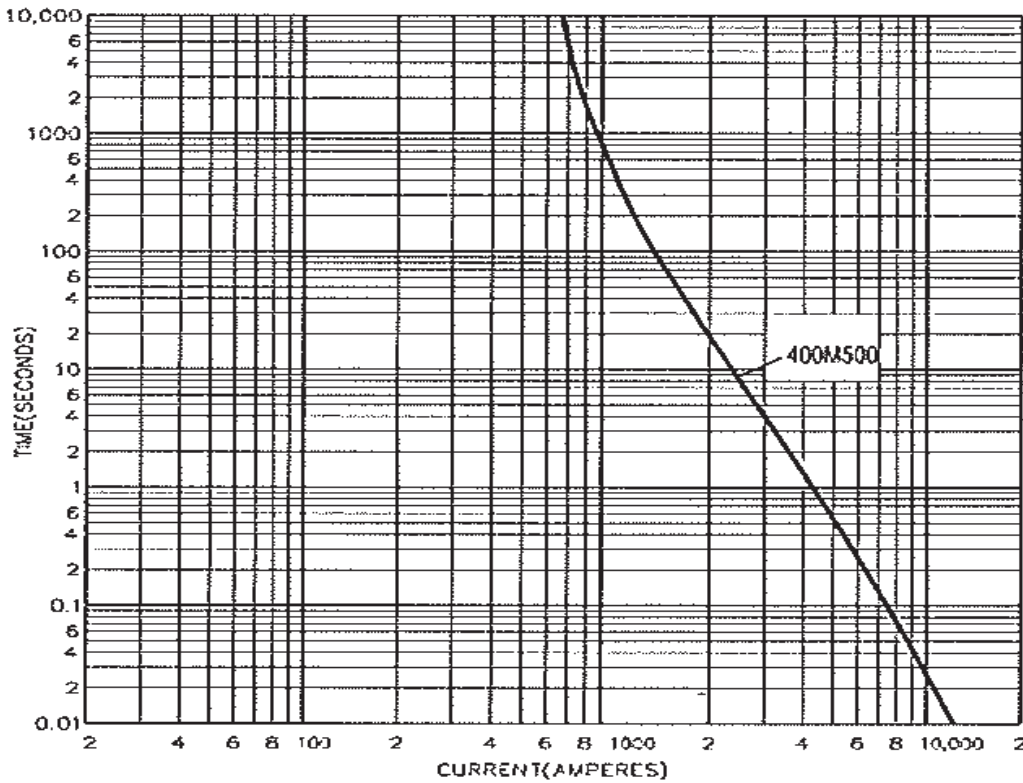

Changes to the products, to the information contained in this document, and to prices are reserved; so are errors and omissions. Only order confirmations and technical documentation by Eaton is binding. Photos and pictures also do not warrant a specific layout or functionality. Their use in whatever form is subject to prior approval by Eaton. The same applies to Trademarks (especially Eaton, Moeller, and Cutler-Hammer). The Terms and Conditions of Eaton apply, as referenced on Eaton Internet pages and Eaton order confirmations.

**Eaton**  
 EMEA Headquarters  
 Route de la Longeraie 7  
 1110 Morges, Switzerland  
 Eaton.eu

© 2015 Eaton  
 All Rights Reserved  
 Publication No. 4120  
 July 2015



Eaton is a registered trademark.

All other trademarks are property of their respective owners.

**CHS Controls AB**  
 Tel +46 42 38 61 00, Fax +46 42 38 61 29  
 chs@chscontrols.se www.chscontrols.se