

# Bussmann series FF BS88 Centre bolted tags



## Product description

Eaton's Bussmann series range of British Standard C2 fuse links is specifically designed for the protection of general industrial applications e.g. power distribution and cable protection.

## Standard features

- Good peak let-through current limitation
- 1:1:6 Selective coordination ratio between "minor" and "major" fuse
- Power loss values well within the limits of IEC 60269

**EATON**

*Powering Business Worldwide*



**CHS Controls AB**

Tel +46 42 38 61 00, Fax +46 42 38 61 29  
chs@chscontrols.se www.chscontrols.se

**Catalogue symbol:**

- FF(Amps)

**Technical data:**

- Rated voltage: 550 V a.c. / 400 V d.c.
- Rated current: 450 to 630 A
- Breaking capacity: 80 kA
- Class of operation: gG
- Size: C2

**Standards/Approvals:**

- BS88
- IEC 60269
- Suitable for use in RoHS compliant applications

**Packaging:**

- MOQ 1

**Table 1. Technical data**

Part number	Rated voltage	Rated current (Amps)	Energy integrals I <sup>2</sup> t (A <sup>2</sup> S)		Watts loss	Dimensions (mm)										Product class	Weight
			Pre-arcing	Total at 415 V a.c.		W	A	B	C	D	E	F	G	H	J		
FF450	550 V a.c. 400V d.c.	450	850	1600	32	210	185	77.5	10.5	15.5	25.4	134	74	6.4	gG	1.055Kg	
FF500	550 V a.c. 400 V d.c.	500	1100	2000	38	210	185	77.5	10.5	15.5	25.4	134	74	6.4	gG	1.055Kg	
FF560	550 V a.c. 400V d.c.	560	1400	2400	43	210	185	77.5	10.5	15.5	25.4	134	74	6.4	gG	1.055Kg	
FF630	550 V a.c. 400V d.c.	630	2000	3500	50	210	185	77.5	10.5	15.5	25.4	134	74	6.4	gG	1.055Kg	

**Outline drawing**

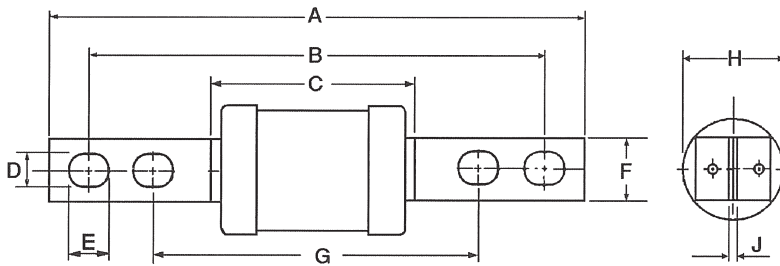

**Time current curve**

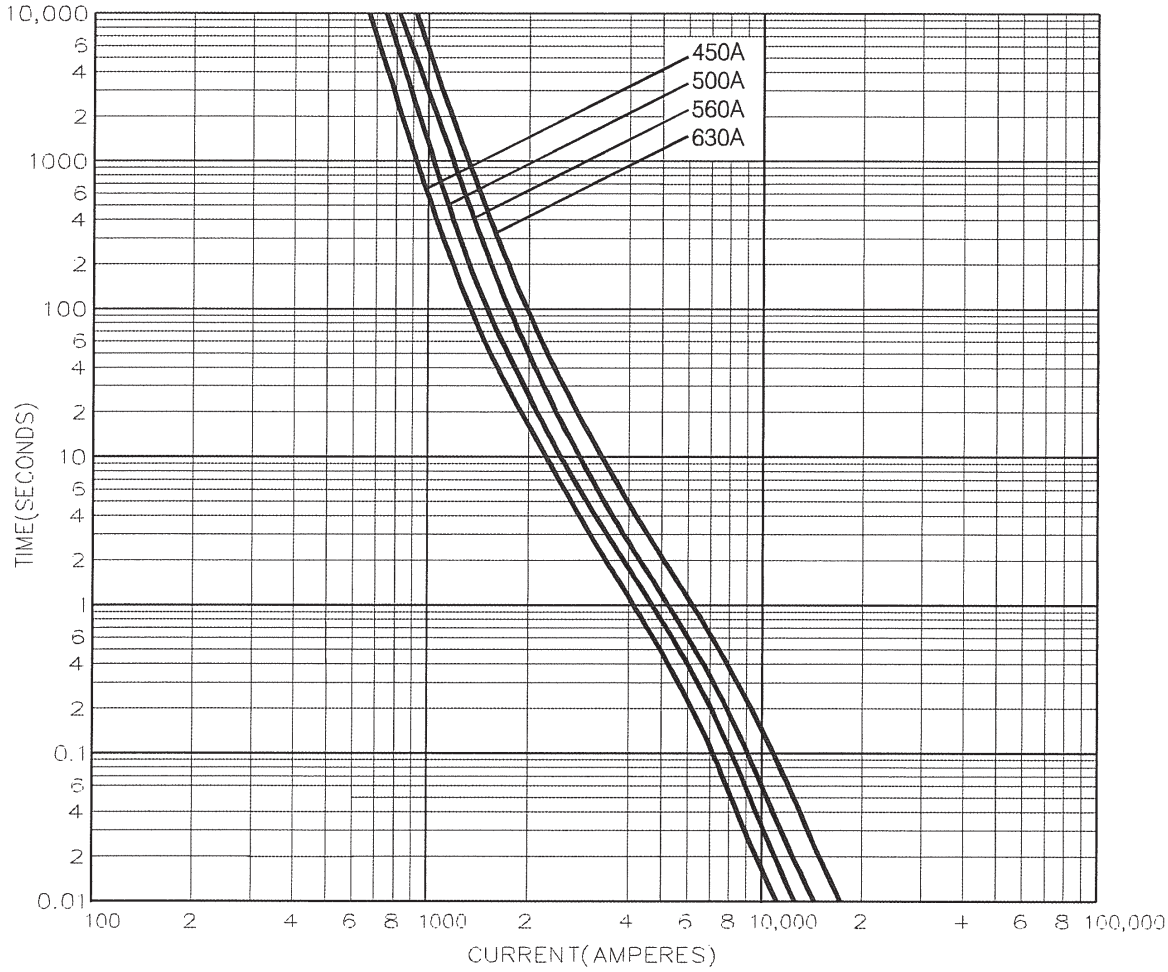

Changes to the products, to the information contained in this document, and to prices are reserved; so are errors and omissions. Only order confirmations and technical documentation by Eaton is binding. Photos and pictures also do not warrant a specific layout or functionality. Their use in whatever form is subject to prior approval by Eaton. The same applies to Trademarks (especially Eaton, Moeller, and Cutler-Hammer). The Terms and Conditions of Eaton apply, as referenced on Eaton Internet pages and Eaton order confirmations.

**Eaton**  
EMEA Headquarters  
Route de la Longeraie 7  
1110 Morges, Switzerland  
Eaton.eu

© 2015 Eaton  
All Rights Reserved  
Publication No. 4102  
June 2015



Eaton is a registered trademark.

All other trademarks are property of their respective owners.



**CHS Controls AB**  
Tel +46 42 38 61 00, Fax +46 42 38 61 29  
chs@chscontrols.se www.chscontrols.se