

EX - PLUGS AND RECEPTACLES

10 A to 125 A
plugs and receptacles plastic version for zone 1, 2, 21 and 22

1 A good connection

Providing electrical energy there, where it is most needed – even in hazardous areas for the Zones 1, 2, 21 and 22.

Non-stationary electrical apparatus have generally high requirements on the energy/power supply. Robust plugs and receptacles as well as a high chemical resistance are at the first glance very important. Electrical reliability is a must not only for all connectivity products.

A high safety standard, a steady hold and faultless contacting even under vibration or the effects of an aggressive atmospheric environment are the basis for a secure and reliable utilisation.

CEAG plugs and receptacles offer more, apart from the proven technology, this product series is defined by its innovative details. For example, the very efficient cable strain relief or the new coding system of the various versions offers different solutions for a secure and problem free utilization in all areas.

Just to round the product off, the user in the normal industrial sector becomes exactly the same product advantages. Robust industrial versions fulfil all requirements appertaining to mechanical and chemical durability. For the stationary repair power supplying in hazardous explosive areas, there is a specially conceived version available that fulfils all the necessary safety requirements. Used in a module sense, individual solutions are no problem at all. The CEAG wall socket for instance can be mounted on to the pre-installed mounting frame without having to use tools – installation without a hot work permit.

Apart from the plugs and receptacles for the European market, we also have plugs and sockets extra for the US market, which are in accordance to all of the necessary standards UL and safety protection systems used there. The available standard range used here, are the 20 A, 30 A, 60 A and 100 A.

International approvals.

- Nickel-plated contacts
- Low insertion force
- Safety standard IP66 applies also in the plugged-in state
- Full AC-3 switching ability
- Self-cleaning lamellar contacts, low transition resistance
- All-pole on/off switching
- Easy plugging



Ex-plugs and receptacles 32 A 4/5-pole up to 690 V



Wall socket



Flange socket



Coupler



Plug

1

Technical data

Ex-plugs and receptacles acc. to IEC 60309-1/2

| | | |
|--|--|---|
| Marking accd. to 2014/34/EU | Wall socket, plug, coupler: Flange socket: | II 2G / Ex db eb IIC / IIB T5 Gb II 2 D Ex tb IIIC T80°C Db II 2G Ex db eb IIC / IIB Gb II 2 D Ex tb IIIC Db |
| EC-Type Examination Certificate | Wall socket, plug, coupler: Flange socket: | BVS 21 ATEX E 001 X BVS 20 ATEX E 090 U |
| IECEX Certificate of Conformity | Wall socket, plug, coupler: Flange socket: | IECEX BVS 21.0002X IECEX BVS 20.0072 U |
| Marking accd. to IECEx | Ex db eb IIC/IIB T5 Gb Ex tb IIIC T80°C Db | |
| EAC (TR) | 1EX d e [ia] IIC/IIB T6 Gb X Ex tb IIIC T80°C Db X | |
| Permissible ambient temperature | Wall socket, plug: Wall socket, plug: Coupler: Flange socket: Flange socket: | IIB -55°C up to +55°C IIC -45°C up to +55°C IIC -25°C up to +55°C IIB -55°C up to +80°C IIC -45°C up to +80°C |
| Rated voltage | up to 690 V (AC) | |
| Rated current | 32 A | |
| Frequency | up to 400 Hz | |
| Rated making / Rated breaking capacity AC-3 accd. EN 60947-3 | U _e 690 V / I _e 32 A | |
| External back up fuse | without thermal protection: 35 A with thermal protection: 50 A gG (rated current 32 A set to) | |
| Protection class | I | |
| Degree of protection accd. to EN 60529 | IP66 | |
| Enclosure colour | black | |

Wall socket

| | |
|--------------------------------|--|
| Cable entry/enclosure drilling | 1 x M40 cable gland, 1 x M40 plastic Ex-screw plug or 2 x M32 metal thread with 2 plastic Ex-screw plug |
| Connecting terminals | 2 x 4 - 10 mm ² |
| Enclosure material | glass-fibre reinforced polyester |

Plug

| | |
|----------------------|-------------------------|
| Cable entry | Ø 12 - 28 mm |
| Connecting terminals | 2.5 - 6 mm ² |
| Enclosure material | Polyamide |

Coupler

| | |
|----------------------|----------------------------|
| Cable entry | Ø 12 - 28 mm |
| Connecting terminals | 2 x 4 - 10 mm ² |
| Enclosure material | Polyamide |

Flange socket

| | |
|----------------------|----------------------------|
| Connecting terminals | 2 x 4 - 10 mm ² |
| Enclosure material | Polyamide |

Details for used cable glands see pages 2.3 ff

Ex-plugs and receptacles 32 A 4/5-pole up to 690 V



Plug



Coupler





Flange socket

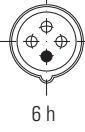

Wall socket

Ordering details

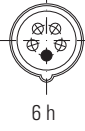
| Voltage | h | Type | Aux. contact | Cable entry | Weight approx. | Order No. |
|-------------------------|---|---------------|---|-------------|----------------|--------------------|
| Type 32 A 4-pole | | | | | | |
| 200-250 V |  | Wall socket | – | KU | 2.3 kg | GHG 512 4409 R0001 |
| | | Wall socket | – | ME | 2.4 kg | GHG 512 4409 R3001 |
| | | Wall socket | – | GM | 2.3 kg | GHG 512 4409 R3003 |
| | | Flange socket | | | 1.0 kg | GHG 512 8409 R0001 |
| | | Coupler | | | 1.55 kg | GHG 512 3409 R0001 |
| | | Plug | | | 0.55 kg | GHG 512 7409 R0001 |
| | | 380-415 V |  | Wall socket | – | KU |
| Wall socket | – | | | ME | 2.4 kg | GHG 512 4406 R3001 |
| Wall socket | yes | | | KH | 2.3 kg | GHG 512 4406 R0501 |
| Wall socket | – | | | GM | 2.4 kg | GHG 512 4406 R3003 |
| Flange socket | | | | | 1.0 kg | GHG 512 8406 R0001 |
| Coupler | | | | | 1.55 kg | GHG 512 3406 R0001 |
| Plug | | | | | 0.55 kg | GHG 512 7406 R0001 |
| 480-500 V |  | Wall socket | – | KU | 2.3 kg | GHG 512 4407 R0001 |
| | | Wall socket | – | ME | 2.4 kg | GHG 512 4407 R3001 |
| | | Wall socket | yes | KH | 2.3 kg | GHG 512 4407 R0501 |
| | | Flange socket | | | 1.0 kg | GHG 512 8407 R0001 |
| | | Coupler | | | 1.55 kg | GHG 512 3407 R0001 |
| | | Plug | | | 0.55 kg | GHG 512 7407 R0001 |
| | | 600-690 V |  | Wall socket | – | KU |
| Wall socket | – | | | ME | 2.4 kg | GHG 512 4405 R3001 |
| Wall socket | yes | | | KH | 2.3 kg | GHG 512 4405 R0501 |
| Flange socket | | | | | 1.0 kg | GHG 512 8405 R0001 |
| Coupler | | | | | 1.55 kg | GHG 512 3405 R0001 |
| Plug | | | | | 0.55kg | GHG 512 7405 R0001 |
| Type 32 A 5-pole | | | | | | |
| 200-250 V 380-415 V |  | Wall socket | – | KU | 2.3 kg | GHG 512 4506 R0001 |
| | | Wall socket | – | ME | 2.4 kg | GHG 512 4506 R3001 |
| | | Wall socket | yes | KH | 2.3 kg | GHG 512 4506 R0501 |
| | | Wall socket | – | GM | 2.4 kg | GHG 512 4506 R3003 |
| | | Flange socket | | | 1.0 kg | GHG 512 8506 R0001 |
| | | Coupler | | | 1.6 kg | GHG 512 3506 R0001 |
| | | Plug | | | 0.6 kg | GHG 512 7506 R0001 |

Other voltage ranges and versions available on request

KU = 1 x plastic cable glands M40, 1 x M40 plastic Ex-screw plug

KH = 1 x plastic cable glands M40, 1 x plastic cable glands M25, with aux. contact

ME = 2 x metal thread M32 with plastic Ex-screw plug

GM = 2 x metal thread M32 with screw plug, with external earth bolt M6

Ex-plugs and receptacles 32 A 4/5-pole up to 690 V



Wall socket



Flange socket



Coupler



Plug

Dimension drawing | Wiring diagram

Dimensions in mm

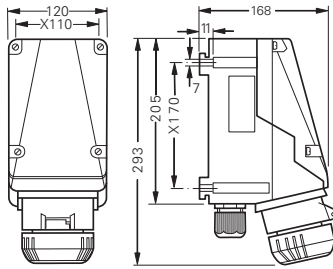

Wall socket 4-pole

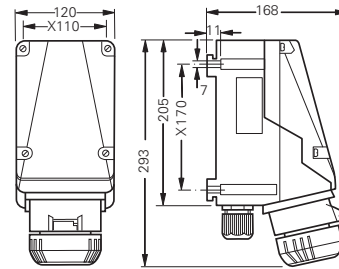

Wall socket 5-pole

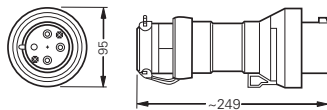

Plug 4-pole

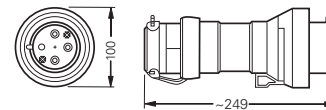

Plug 5-pole

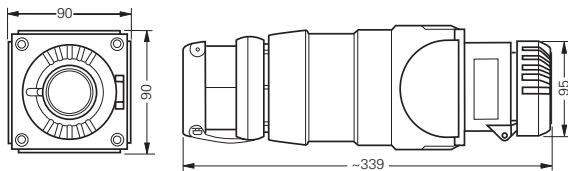

Coupler 4-pole

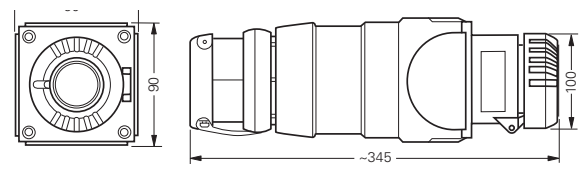

Coupler 5-pole

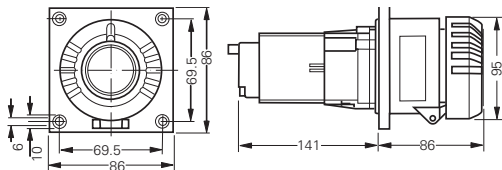

Flange socket 4-pole

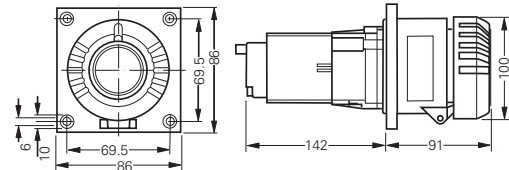

Flange socket 5-pole

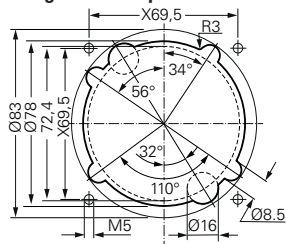

Assembly dimensions flange socket

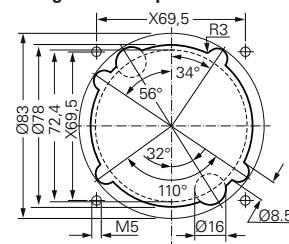

Assembly dimensions flange socket X = fixing dimensions

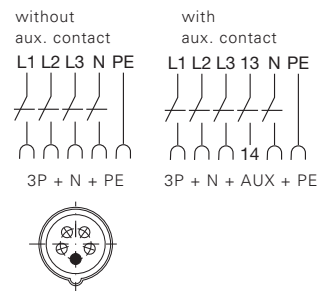
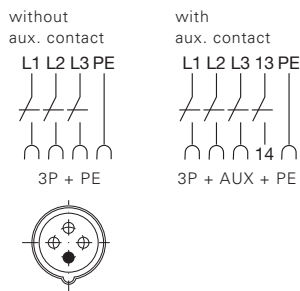



Angle adapter



Protective canopy



Plug cap

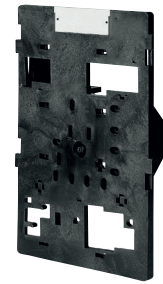

GHG 610 1901 R0128

Accessories

| Type | Application | Fixing method | Order No. |
|--|----------------------|---------------|--------------------|
| Mounting plates for wall sockets 32 A | | | |
| Size 5 | for wall mounting | snap on | GHG 610 1953 R0128 |
| Size 5 | for trellis mounting | snap on | GHG 610 1953 R0128 |
| Size 5 | for pipe clamp | snap on | GHG 610 1953 R0132 |

| Type | Order No. |
|--------------------------------|--------------------|
| Plug cap for plugs 32 A | |
| Plug 32 A 4-pole | GHG 510 1901 R0004 |
| Plug 32 A 5-pole | GHG 510 1901 R0005 |

| Type | OU | Order No. |
|---|----|--------------------|
| Accessories for mounting plates | | |
| Mounting set for pipes 1" (Ø 27 - 30 mm) for mounting plates with pipe fixing | 10 | GHG 610 1953 R0020 |

Please pay attention that only order units (OU) according to the ordering details can be delivered.

| Type | Application | Order No. |
|---|------------------------------------|--------------------|
| Protective canopy for mounting plate | | |
| Size 5 | for mounting plate size 5, snap on | GHG 610 1955 R0108 |

| Type | Application | Fixing method | Order No. |
|---|----------------|---------------|--------------------|
| Angle adapter for Wall socket 32 A | | | |
| 32 A 4/5-pol | Panel mounting | screw | GHG 510 1921 R0002 |

Dimension drawing

Dimensions in mm

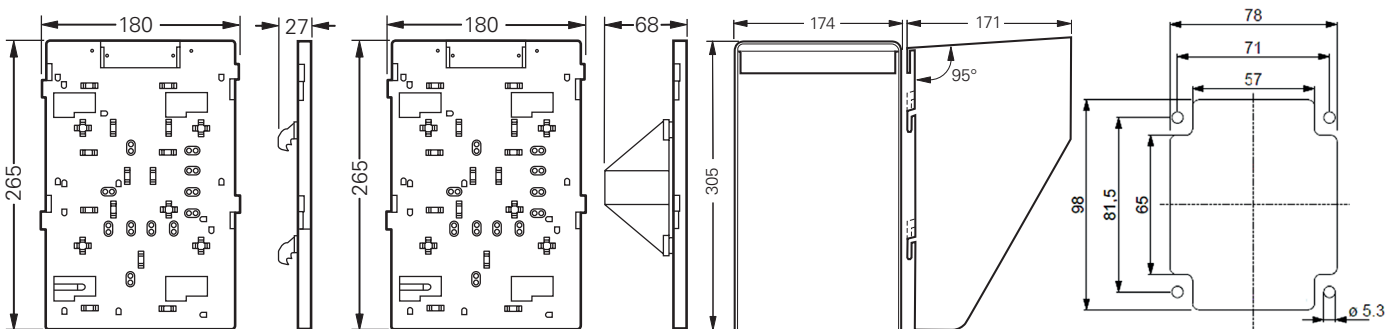

Mounting plate size 5 for wall/trellis mounting

Mounting plate size 5 for pipe mounting

Protective canopy size 5

Angle adapter 16/32 A 4/5-pol.

Dimensions in mm